

(Residents - Owners or Renters)

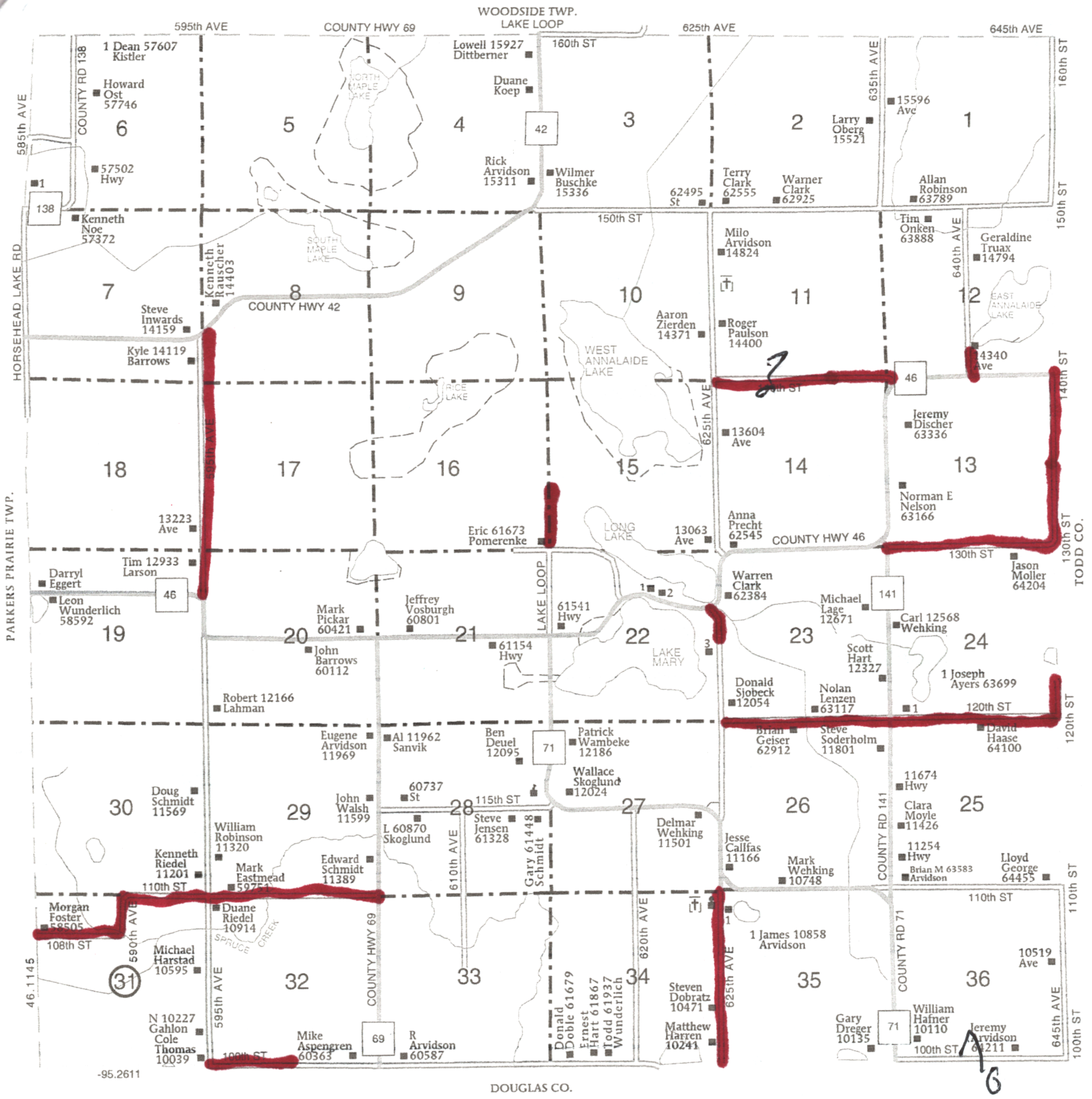

EASTERN TOWNSHIP

SECTION 22

- 1 Guse, Tom 62009
- 2 62169
- 3 Wiirre, Landy 12477

Traditional Values. Continuing Excellence.

# BORK LUMBER & STEEL, INC.

ph: 320-243-7815  
18508 Co. Rd. 130, Paynesville, MN  
[www.borklumber.com](http://www.borklumber.com)

**Your Source for:**

- Free Stall Barns
- Parlors
- Round Roof Barn Remodels
- Machine Sheds
- Shops
- Hog Confinements
- Turkey Barns
- Chicken Barns
- Portable Buildings